

<b>2. Technik / Grundlagen</b> .....	2
2.5.3 Türstärke 50 mm .....	2

Türstärke 50 mm

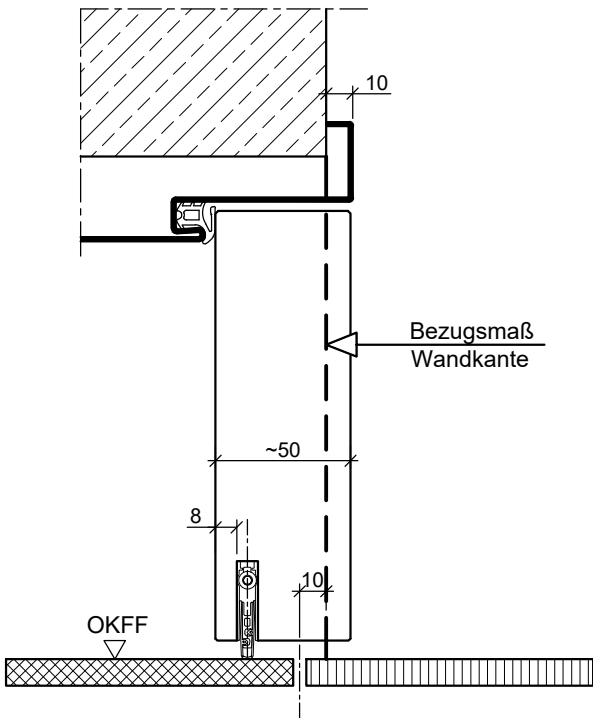

HW50-stumpf in Stahlzarge

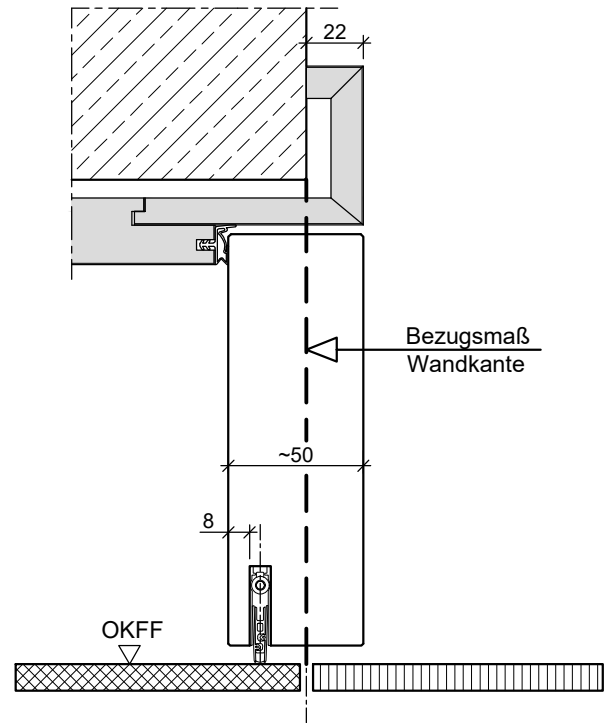

HW50-stumpf in Holzumfassungszarge

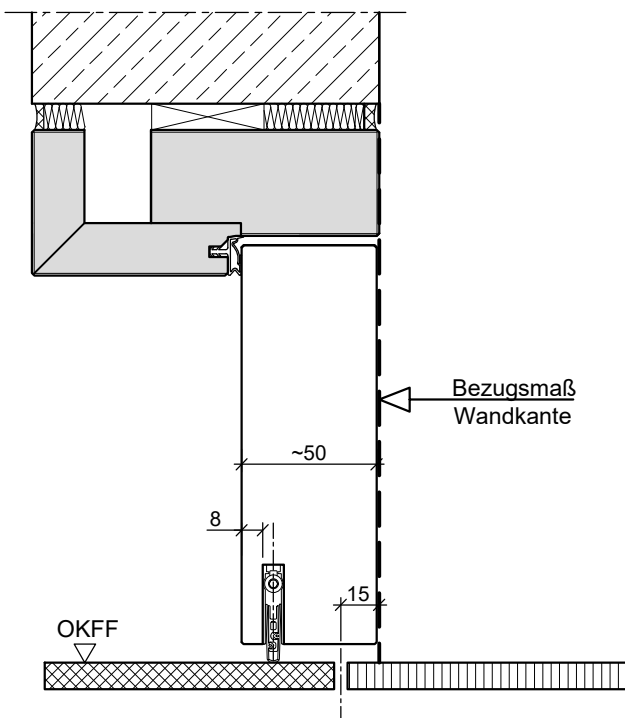

HW50-stumpf in Holzblockzarge

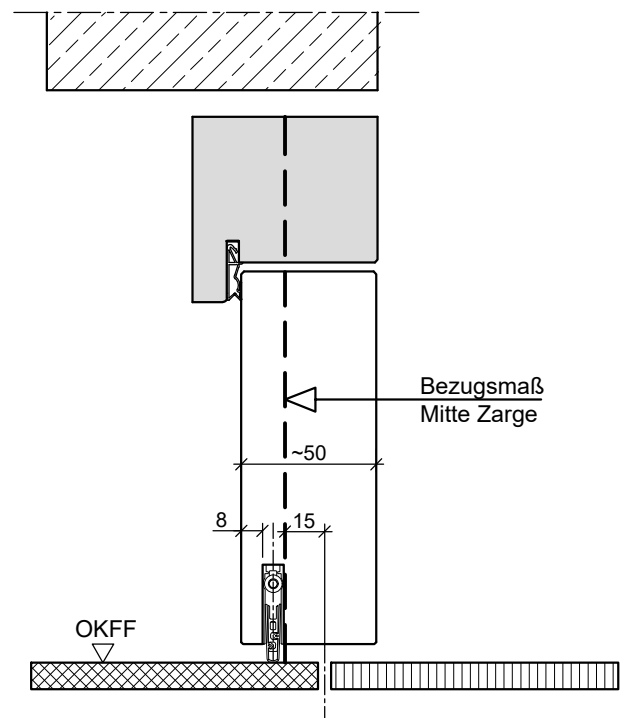

HW50-stumpf in Stockzarge

Türstärke 50 mm

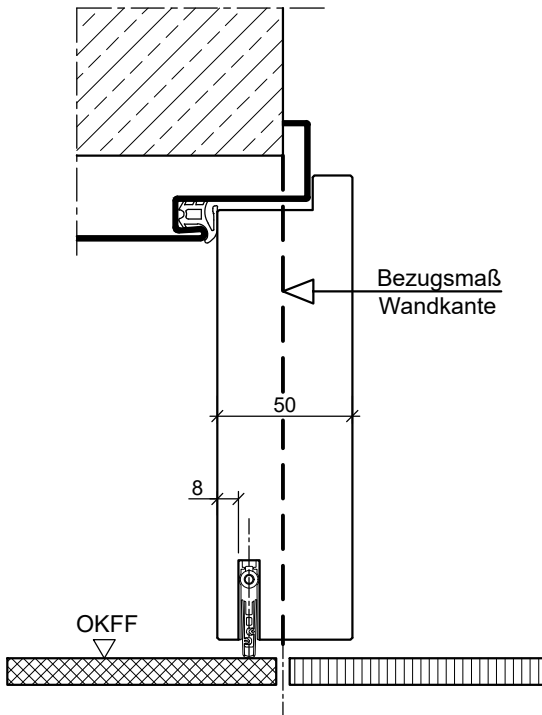

HW50-gefälzt Stahlzarge

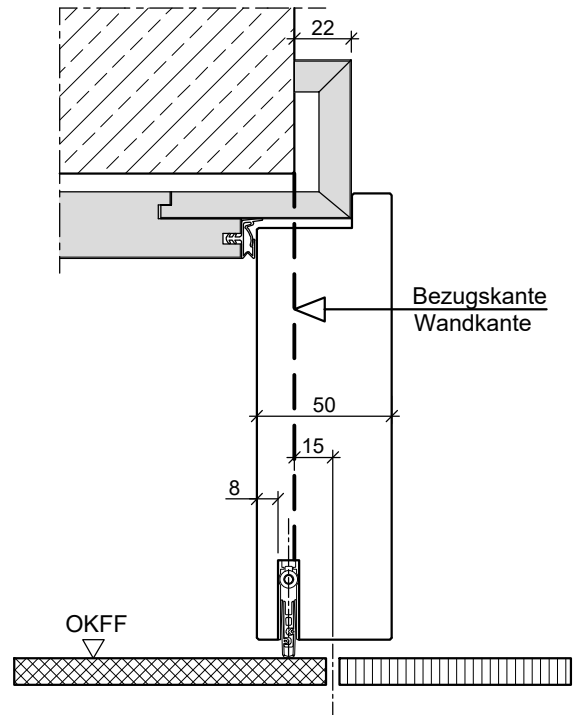

HW50-gefälzt in Holzumfassungszarge

Türstärke 50 mm

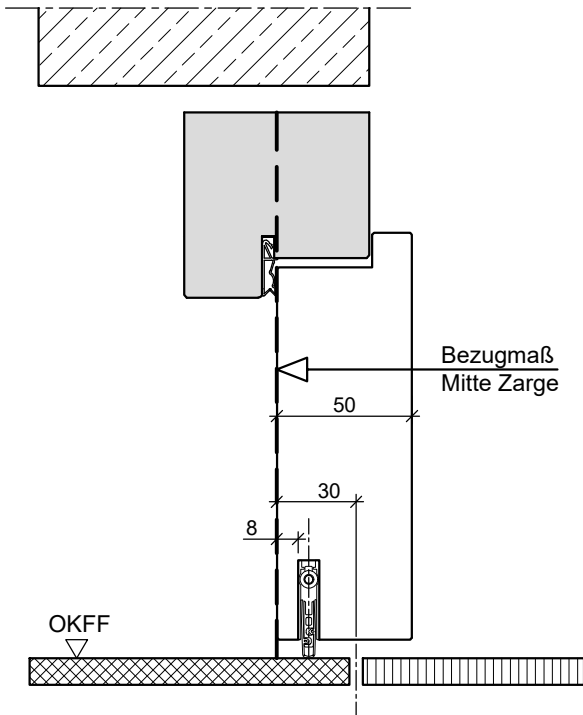

HW50-gefälzt in Stockzarge